

## MVF90D Series

### SPECIFICATION

Max. Vacuum level	: -92Kpa(-690mmHg)
Supply Air pressure	: 4 - 6bar, Max. 6.5bar
Supply Air type	: Dry Compressed Air
Working temperature range	: -20°C to +80°C
Noise level	: 50-60dBA
Material	: AL, ABS, Glass Filled Nylon
Sealing Material	: NBR(standard) Option: silicon, viton



### CHARACTERISTIC

Model	Max.vacuum -Kpa(-mmHg)	Max.vacuum flow (L/min)	Air consumption (L/min)	Capacity equivalent to electricity motor pump size
<b>MVF90D-20</b>	92(690)	568	150 - 188	0.5 kw
<b>MVF90D-30</b>	92(690)	852	225 - 282	0.75 kw
<b>MVF90D-40</b>	92(690)	1100	300 - 376	1 kw
<b>MVF90D-50</b>	92(690)	1349	375 - 470	1.25 kw
<b>MVF90D-60</b>	92(690)	1527	450 - 564	1.5 kw

### DIMENSIONAL INFORMATION

Model	Size(mm)				
	L	W	T	H	B
<b>MVF90D-20</b>	194	80	43	166	159
<b>MVF90D-30</b>	194	80	43	166	159
<b>MVF90D-40</b>	194	80	64	187	159
<b>MVF90D-50</b>	194	80	64	187	159
<b>MVF90D-60</b>	194	80	64	187	159

Accessories	
- Vacuum Gauge	1 pcs
- Silencer	2 pcs
- Bracket	2 pcs
- Bolt	2 pcs

- ① Compressed Air G1/4"
- ② Vacuum G3/4"
- ③ Vacuum G3/8"
- ④ Exhaust G3/4"

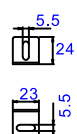
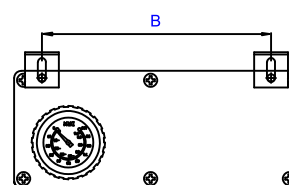
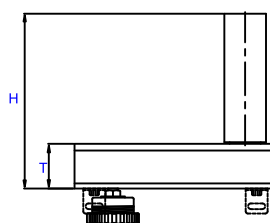
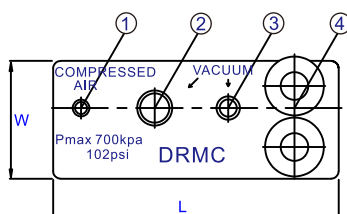

## MVF90D Series flow

Time in seconds to evacuate to vacuum level (Sec/1000L)

Model	Vacuum level (-kPa)									
	0	10	20	30	40	50	60	70	80	90
<b>MVF90D-20</b>	0	12	31	69	154	269	431	688	1169	2680
<b>MVF90D-30</b>	0	8	21	46	103	179	288	458	779	1787
<b>MVF90D-40</b>	0	6	16	35	79	139	223	355	603	1383
<b>MVF90D-50</b>	0	5	13	29	65	113	182	289	492	1128
<b>MVF90D-60</b>	0	4	12	26	57	100	160	256	435	997

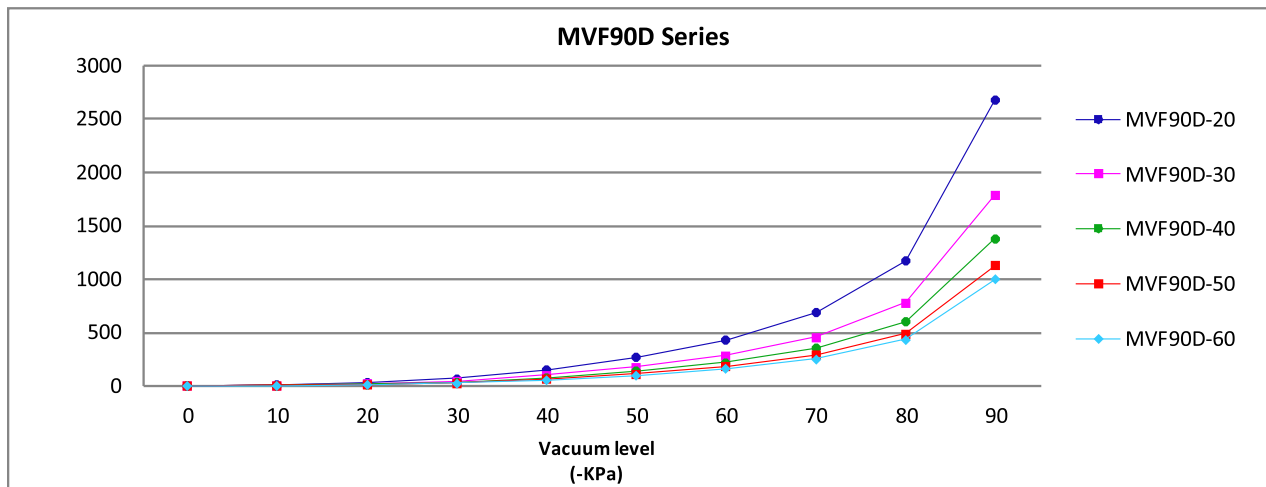

Vacuum flow at different Vacuum levels (L/Min)

Model	Vacuum level (-kPa)									
	0	10	20	30	40	50	60	70	80	90
<b>MVF90D-20</b>	568	328	213	104	74	58	38	22	10	0
<b>MVF90D-30</b>	852	492	319	156	110	86	58	34	14	0
<b>MVF90D-40</b>	1101	636	412	202	143	112	74	43	19	0
<b>MVF90D-50</b>	1349	779	505	247	175	137	91	53	23	0
<b>MVF90D-60</b>	1527	882	572	280	198	155	103	60	26	0

